

PLANETARY AUGER DRIVES



Suit Machine up to 2.5 tonne including Micro & Mini excavators, mini loaders and small skid steer loaders.

Features

- High quality EATON/DIGGA Bell motor
- Highly efficient design, less moving parts, increased efficiency
- Compact, powerful Digga planetary gearbox
- Drive can go down the hole for greater digging depth
- 2 Piece shaft, lifetime pullout warranty
- Low maintenance with industry leading warranty

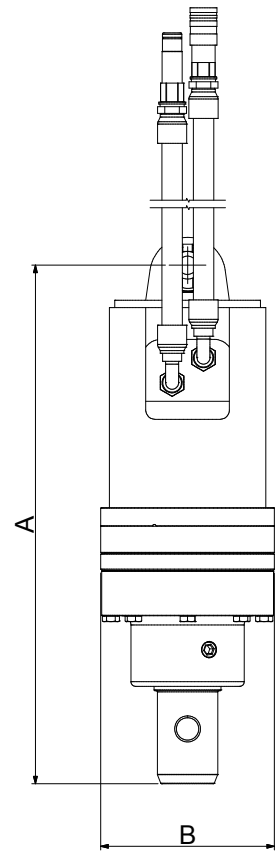

Model	PDD	PDX	PDX2	PDX3
Min Rec Flow	15 lpm	20 lpm	30 lpm	30 lpm
Max Rec Flow	45 lpm	50 lpm	50 lpm	55 lpm
Max Torque (Nm) @ 240 bar	1200	1,800	2350	2850
Pressure Valve Fitted	NA	NA	Optional	Optional
Max Pressure (Bar)	240	240	240	240
Max Flow (lpm)	115	115	115	115
Max Kw	28	28	28	28
Overall Length (mm)	557	557	557	579
Diameter (mm)	187	187	187	187
Weight (No linkage and hitch)	45	45	45	45
STD Output Shaft	65mm Round	65mm Round	65mm Round	65mm Round
Swing Control (SCS)	NA	NA	Optional	Optional
Diggalign (Auger Alignment)	NA	NA	NA	NA
Recommended Auger Diameter				
Recommended Auger	A4/AGS	A4/AGS	A4/AGS	A4/AGS
Max Auger Dia Clay/Shale*	400mm	400mm	450mm	450mm
Max Auger Dia Earth*	500mm	500mm	600mm	600mm

PDD				PDX				PDX2				PDX3			
Output Speed		Output Torque		Output Speed		Output Torque		Output Speed		Output Torque		Output Speed		Output Torque	
Lpm	RPM	Bar	Nm	Lpm	RPM	Bar	Nm	Lpm	RPM	Bar	Nm	Lpm	RPM	Bar	Nm
15	49	120	600	20	44	120	900	30	50	120	1150	30	41	120	1450
20	66	140	700	25	55	140	1050	35	58	140	1350	35	47	140	1650
25	82	160	800	30	66	160	1200	40	66	160	1550	40	54	160	1900
30	98	180	900	35	77	180	1300	45	75	180	1750	45	61	180	2150
35	115	200	1000	40	88	200	1450	50	83	200	2000	50	68	200	2400
40	131	220	1100	45	99	220	1600			220	2150	55	74	220	2600
45	148	240	1200	50	110	240	1800			240	2350			240	2850

Output speed and torque specifications are THEORETICAL. Speed and torque output are dependent on the overall system efficiencies associated with the prime movers hydraulic system. This document should be used for information and comparative purposes only. When determining criteria, & application specific information is required, please contact DIGGA.

PLANETARY AUGER DRIVES



Suit Machine 2.5 - 6 tonne including Excavators & Skid Steer Loaders

Features

- High quality EATON/DIGGA Bell motor
- Highly efficient design, less moving parts, increased efficiency
- Compact, powerful Digga planetary gearbox
- Drive can go down the hole for greater digging depth
- 2 Piece shaft, lifetime pullout warranty
- Low maintenance with industry leading warranty

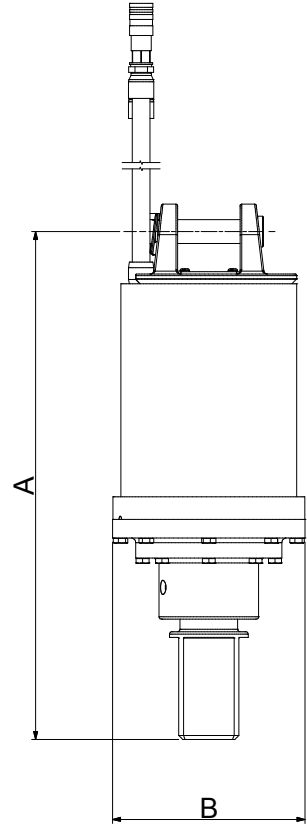

Model	PD3	PD4	PD5
Min Rec Flow	45 lpm	55 lpm	60 lpm
Max Rec Flow	75 lpm	85 lpm	95 lpm
Max Torque (Nm) @ 240 bar	3600	4450	5150
Pressure Valve Fitted	Optional	Optional	Optional
Max Pressure (Bar)	240	240	240
Max Flow (lpm)	115	115	115
Max Kw	28	28	28
Overall Length (mm)	579	579	579
Diameter (mm)	240	240	240
Weight (No linkage and hitch)	56	56	62
STD Output Shaft	65mm Round	65mm Round	75mm Square
Swing Control (SCS)	Optional	Optional	Optional
Diggalign (Auger Alignment)	Optional	Optional	Optional
Recommended Auger Diameter			
Recommended Auger	A4/AGS	A4/AGS	A5/A6/A7
Max Auger Dia Clay/Shale*	600mm	750mm	900mm
Max Auger Dia Earth*	750mm	900mm	1000mm

PD3				PD4				PD5			
Output Speed		Output Torque		Output Speed		Output Torque		Output Speed		Output Torque	
Lpm	RPM	Bar	Nm	Lpm	RPM	Bar	Nm	Lpm	RPM	Bar	Nm
45	49	120	1800	55	47	120	2250	60	45	120	2600
50	54	140	2100	60	52	140	2600	65	48	140	3050
55	59	160	2400	65	56	160	3000	70	52	160	3450
60	65	180	2700	70	60	180	3350	75	56	180	3900
65	70	200	3000	75	64	200	3750	80	60	200	4300
70	75	220	3300	80	69	220	4100	85	63	220	4750
75	81	240	3600	85	73	240	4450	90	67	240	5150
								95	70		

Output speed and torque specifications are THEORETICAL. Speed and torque output are dependent on the overall system efficiencies associated with the prime movers hydraulic system. This document should be used for information and comparative purposes only. When determining criteria, & application specific information is required, please contact DIGGA.

PLANETARY AUGER DRIVES



Suit Machine 5-8 tonne including excavators & skid steer loaders, truck cranes, front end loaders, wheeled loaders and backhoes

Features

- High quality EATON/DIGGA Bell motor
- Highly efficient design, less moving parts, increased efficiency
- Compact, powerful Digga planetary gearbox
- Drive can go down the hole for greater digging depth
- 2 Piece shaft, lifetime pullout warranty
- Low maintenance with industry leading warranty

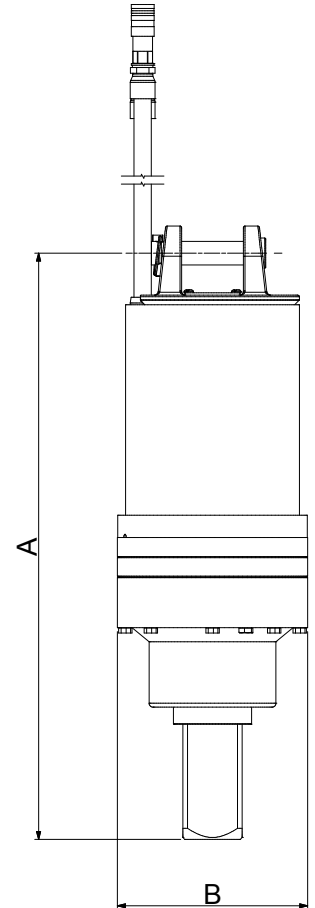

Model	PD6		PD7		PD6				PD7			
	Output Speed	Output Torque	Output Speed	Output Torque	Lpm	RPM	Bar	Nm	Lpm	RPM	Bar	Nm
Min Rec Flow	70 lpm	75 lpm	70	48	75	48	120	2800	75	48	120	3050
Max Rec Flow	115 lpm	115 lpm	75	51	80	51	140	3300	80	51	140	3550
Max Torque (Nm) @ 240 bar	5600	6050	80	55	85	54	160	3750	85	54	160	4050
Pressure Valve Fitted	Optional	Optional	85	58	90	57	180	4200	90	57	180	4550
Max Pressure (Bar)	240	240	90	61	95	60	200	4700	95	60	200	5050
Max Flow (lpm)	115	115	95	65	100	63	220	5150	100	63	220	5550
Max Kw	28	28	100	68	105	66	240	5600	105	66	240	6050
Overall Length (mm)	730	734	105	72	110	70			110	70		
Diameter (mm)	240	240	110	75	115	73			115	73		
Weight (No linkage and hitch)	84	100										
STD Output Shaft	75mm Square	75mm Square										
Swing Control (SCS)	Optional	Optional										
Diggalign (Auger Alignment)	Optional	Optional										
Recommended Auger Diameter												
Recommended Auger	A5/A6/A7		A5/A6/A7									
Max Auger Dia Clay/Shale*	900mm		900mm									
Max Auger Dia Earth*	1000mm		1000mm									

Output speed and torque specifications are THEORETICAL. Speed and torque output are dependent on the overall system efficiencies associated with the prime movers hydraulic system. This document should be used for information and comparative purposes only. When determining criteria, & application specific information is required, please contact DIGGA.

PLANETARY AUGER DRIVES



Suit Machine 7-12 tonne including excavators, truck cranes, front end loaders, wheeled loaders and backhoes

Features

- High quality EATON/DIGGA Bell motor
- Highly efficient design, less moving parts, increased efficiency
- Compact, powerful Digga planetary gearbox
- Drive can go down the hole for greater digging depth
- 2 Piece shaft, lifetime pullout warranty
- Low maintenance with industry leading warranty

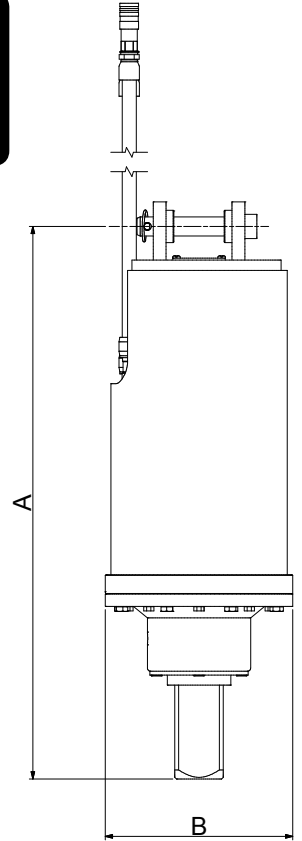

Model	PD8	PD10
Min Rec Flow	80 lpm	85 lpm
Max Rec Flow	115 lpm	115 lpm
Max Torque (Nm) @ 240 bar	7050	8500
Pressure Valve Fitted	Optional	Optional
Max Pressure (Bar)	240	240
Max Flow (lpm)	115	115
Max Kw	28	28
Overall Length (mm)	854	854
Diameter (mm)	290	290
Weight (No linkage and hitch)	107	110
STD Output Shaft	75mm Square	75mm Square
Swing Control (SCS)	Optional	Optional
Diggalign (Auger Alignment)	Optional	Optional
Recommended Auger Diameter		
Recommended Auger	A6/A7	A6/A7
Max Auger Dia Clay/Shale*	1000mm	1000mm
Max Auger Dia Earth*	1200mm	1500mm

PD8				PD10			
Output Speed		Output Torque		Output Speed		Output Torque	
Lpm	RPM	Bar	Nm	Lpm	RPM	Bar	Nm
80	44	120	3550	85	38	120	4250
85	46	140	4100	90	41	140	4950
90	49	160	4700	95	43	160	5650
95	52	180	5300	100	45	180	6400
100	54	200	5850	105	47	200	7100
105	57	220	6450	110	50	220	7800
110	60	240	7050	115	52	240	8500
115	63						

Output speed and torque specifications are THEORETICAL. Speed and torque output are dependent on the overall system efficiencies associated with the prime movers hydraulic system. This document should be used for information and comparative purposes only. When determining criteria, & application specific information is required, please contact DIGGA.

PLANETARY AUGER DRIVES



Suit Machine 4-12 tonne including skid steer loaders, excavators, truck cranes, front end loaders, wheeled loaders and backhoes

Features

- High quality EATON/DIGGA Bell motor
- Highly efficient design, less moving parts, increased efficiency
- Compact, powerful Digga planetary gearbox
- Drive can go down the hole for greater digging depth
- 2 Piece shaft, lifetime pullout warranty
- Low maintenance with industry leading warranty
- Integrated PRV (Pressure Relief Valve)
- No case drains required

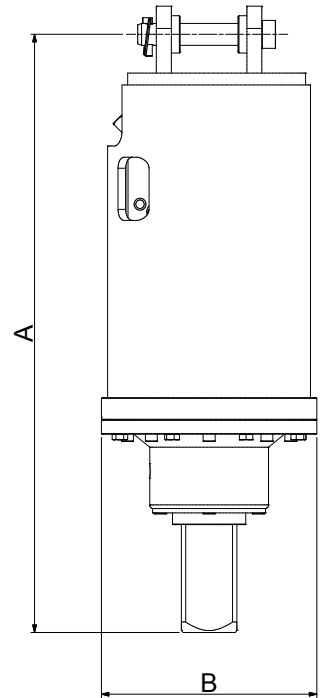

Model	PD4HF	PD6HF	PD8HF	PD10HF
Min Rec Flow	70 lpm	70 lpm	100 lpm	100 lpm
Max Rec Flow	150 lpm	150 lpm	200 lpm	200 lpm
Max Torque (Nm) @ 240 bar	4500	5600	7150	9750
Pressure Valve Fitted	Included	Included	Included	Included
Max Pressure (Bar)	240	240	240	240
Max Flow (lpm)	230	230	230	230
Max Kw	60	60	60	60
Overall Length (mm)	950	950	950	950
Diameter (mm)	290	290	290	290
Weight (No linkage and hitch)	149	149	149	149
STD Output Shaft	75mm Square	75mm Square	75mm Square	75mm Square
Swing Control (SCS)	Optional	Optional	Optional	Optional
Diggalign (Auger Alignment)	Optional	Optional	Optional	Optional
Recommended Auger Diameter				
Recommended Auger	A5/A6/A7	A5/A6/A7	A6/A7	A6/A7
Max Auger Dia Clay/Shale*	750mm	900mm	1000mm	1000mm
Max Auger Dia Earth*	1000mm	1200mm	1200mm	1500mm

PD4HF				PD6HF				PD8HF				PD10HF			
Output Speed		Output Torque		Output Speed		Output Torque		Output Speed		Output Torque		Output Speed		Output Torque	
Lpm	RPM	Bar	Nm	Lpm	RPM	Bar	Nm	Lpm	RPM	Bar	Nm	Lpm	RPM	Bar	Nm
50	43	120	2250	60	41	120	2850	80	43	120	3600	100	39	120	4850
70	60	140	2650	80	54	140	3300	100	54	140	4200	120	47	140	5700
90	77	160	3000	100	68	160	3800	120	64	160	4800	140	55	160	6500
110	94	180	3350	120	81	180	4250	140	75	180	5350	160	63	180	7300
130	111	200	3750	140	95	200	4700	160	86	200	5950	180	71	200	8100
150	128	220	4100	150	102	220	5200	180	96	220	6550	200	79	220	8900
		240	4500			240	5600			240	7150			240	9750

Output speed and torque specifications are THEORETICAL. Speed and torque output are dependent on the overall system efficiencies associated with the prime movers hydraulic system. This document should be used for information and comparative purposes only. When determining criteria, & application specific information is required, please contact DIGGA.

PLANETARY AUGER DRIVES



Suit Machine 12-15 tonne including excavators, truck cranes, front end loaders, wheeled loaders and backhoes

Features

- High quality EATON/DIGGA Bell motor
- Highly efficient design, less moving parts, increased efficiency
- Compact, powerful Digga planetary gearbox
- Drive can go down the hole for greater digging depth
- 2 Piece shaft, lifetime pullout warranty
- Low maintenance with industry leading warranty
- Integrated PRV (Pressure Relief Valve)
- No Case Drains required

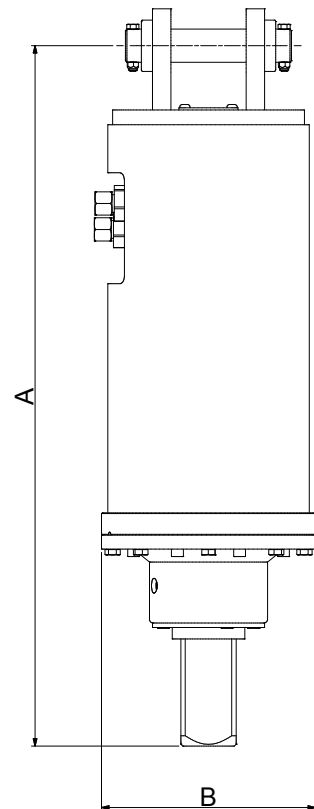

Model	PD12
Min Rec Flow	70 lpm
Max Rec Flow	230 lpm
Max Torque (Nm) @ 240 bar	11300
Pressure Valve Fitted	Included
Max Pressure (Bar)	240
Max Flow (lpm)	230
Max Kw	60
Overall Length (mm)	950
Diameter (mm)	290
Weight (No linkage and hitch)	149
STD Output Shaft	75mm Square
Swing Control (SCS)	Optional
Diggalign (Auger Alignment)	Optional
Recommended Auger Diameter	
Recommended Auger	A8/A9
Max Auger Dia Clay/Shale*	1200mm
Max Auger Dia Earth*	1600mm

PD12			
Output Speed		Output Torque	
Lpm	RPM	Bar	Nm
120	41	120	5650
130	44	140	6600
140	47	160	7550
150	51	180	8450
160	54	200	9400
170	58	220	10350
180	61	240	11300
190	64		
200	68		
210	71		
220	75		
230	78		

Output speed and torque specifications are THEORETICAL. Speed and torque output are dependent on the overall system efficiencies associated with the prime movers hydraulic system. This document should be used for information and comparative purposes only. When determining criteria, & application specific information is required, please contact DIGGA.

PLANETARY AUGER DRIVES



Suit Excavators 15-22 tonne

Features

- High quality EATON/DIGGA Bell motor
- Highly efficient design, less moving parts, increased efficiency
- Compact, powerful Digga planetary gearbox
- Drive can go down the hole for greater digging depth
- 2 Piece shaft, lifetime pullout warranty
- Low maintenance with industry leading warranty
- Integrated PRV (Pressure Relief Valve)
- No case drains required

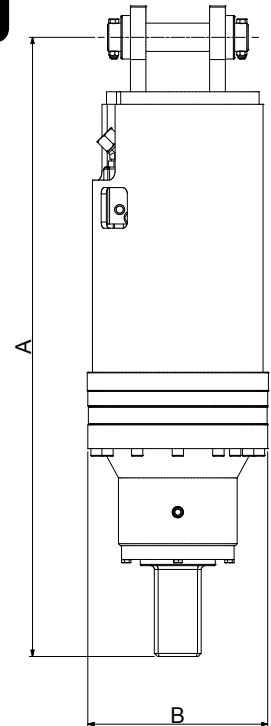

Model	PD15	PD18	PD22
Min Rec Flow	70 lpm	70 lpm	70 lpm
Max Rec Flow	230 lpm	230 lpm	230 lpm
Max Torque (Nm) @ 240 bar	13,900	17,600	22,250
Pressure Valve Fitted	Included	Included	Included
Max Pressure (Bar)	240	240	240
Max Flow (lpm)	230	230	230
Max Kw	60	60	60
Overall Length (mm)	1006	1006	1006
Diameter (mm)	209	290	290
Weight (No linkage and hitch)	176	176	176
STD Output Shaft	75mm Square	75mm Square	75mm Square
Swing Control (SCS)	Optional	Optional	Optional
Diggaalign (Auger Alignment)	Optional	Optional	Optional
Recommended Auger Diameter			
Recommended Auger	A8/A9	A8/A9	A8/A9
Max Auger Dia Clay/Shale*	1200mm	1500mm	1500mm
Max Auger Dia Earth*	1600mm	1600mm	1600mm

PD15				PD18				PD22			
Output Speed		Output Torque		Output Speed		Output Torque		Output Speed		Output Torque	
Lpm	RPM	Bar	Nm	Lpm	RPM	Bar	Nm	Lpm	RPM	Bar	Nm
120	33	120	6,700	120	26	120	8,800	120	21	120	11,150
130	36	140	8,150	130	28	140	10,300	130	22	140	13,000
140	39	160	9,300	140	30	160	11,750	140	24	160	14,850
150	41	180	10,450	150	33	180	13,200	150	26	180	16,700
160	44	200	11,600	160	35	200	14,700	160	28	200	18,550
170	47	220	12,750	170	37	220	16,150	170	29	220	20,400
180	50	240	13,900	180	39	240	17,600	180	31	240	22,250
190	52			190	41			190	33		
200	55			200	43			200	34		
210	58			210	46			210	36		
220	61			220	48			220	38		
230	63			230	50			230	40		

Output speed and torque specifications are THEORETICAL. Speed and torque output are dependent on the overall system efficiencies associated with the prime movers hydraulic system. This document should be used for information and comparative purposes only. When determining criteria, & application specific information is required, please contact DIGGA.

PLANETARY AUGER DRIVES



Suit Excavators 24-50 tonne

Features

- High quality EATON/DIGGA Bell motor
- Highly efficient design, less moving parts, increased efficiency
- Compact, powerful Digga planetary gearbox
- Drive can go down the hole for greater digging depth
- 2 Piece shaft, lifetime pullout warranty
- Low maintenance with industry leading warranty
- Integrated PRV (Pressure Relief Valve)
- No Case Drains required

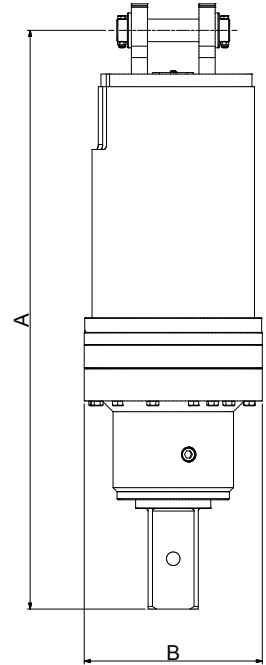

Model	PD25	PD30	PD40	PD50
Min Rec Flow	70 lpm	70 lpm	70 lpm	70 lpm
Max Rec Flow	230 lpm	230 lpm	230 lpm	230lpm
Max Torque (Nm) @ 240 bar	25,800	30,300	32,700	38,400
Pressure Valve Fitted	Included	Included	Included	Included
Max Pressure (Bar)	240	240	240	240
Max Flow (lpm)	230	230	230	230
Max Kw	60	60	60	60
Overall Length (mm)	1152	1152	1152	1152
Diameter (mm)	355	355	355	355
Weight (No linkage and hitch)	300	300	300	300
STD Output Shaft	100mm Square	100mm Square	100mm Square	100mm Square
Swing Control (SCS)	Optional	Optional	Optional	Optional
Diggalign (Auger Alignment)	Optional	Optional	Optional	Optional
Recommended Auger Diameter				
Recommended Auger	A10/A11	A10/A11	A10/A11	A10/A11
Max Auger Dia Clay/Shale*	1200mm	1200mm	1500mm	1500mm
Max Auger Dia Earth*	1600mm	1600mm	1800mm	1800mm

PD25				PD30				PD40				PD50			
Output Speed		Output Torque		Output Speed		Output Torque		Output Speed		Output Torque		Output Speed		Output Torque	
Lpm	RPM	Bar	Nm	Lpm	RPM	Bar	Nm	Lpm	RPM	Bar	Nm	Lpm	RPM	Bar	Nm
120	17	120	13,150	120	15	120	15,300	120	14	120	16,550	120	12	120	19,250
130	19	140	15,350	130	16	140	17,850	130	15	140	19,300	130	13	140	22,450
140	20	160	17,550	140	18	160	20,400	140	16	160	22,100	140	14	160	25,650
150	22	180	19,700	150	19	180	22,950	150	17	180	24,800	150	15	180	28,850
160	23	200	21,900	160	20	200	25,450	160	19	200	27,550	160	16	200	32,050
170	25	220	24,100	170	21	220	28,000	170	20	220	30,300	170	17	220	35,250
180	26	240	25,800	180	23	240	30,300	180	21	240	32,700	180	18	240	38,400
190	28			190	24			190	22			190	19		
200	29			200	25			200	23			200	20		
210	31			210	26			210	24			210	21		
220	32			220	28			220	25			220	22		
230	33			230	29			230	27			230	23		

Output speed and torque specifications are THEORETICAL. Speed and torque output are dependent on the overall system efficiencies associated with the prime movers hydraulic system. This document should be used for information and comparative purposes only. When determining criteria, & application specific information is required, please contact DIGGA.